

**EN**

**Special programming**  
Garage door operator

# 1 Special programming

In addition to the various functions and the respective parameters, there are two types of special programming that you can apply to the garage door operator.

The special programming can only take place when

- The operator is at rest.
- No radio code is being taught in.

**⚠ CAUTION**

**Danger of injury due to improper setting!**  
Special programming that changes the factory setting may only be done by specialists. Changes made by unqualified persons can cause substantial danger to life and limb.

▶ Contact your specialist dealer.

## 1.1 Power limit

The power limit in the OPEN direction is a protective function designed to prevent people from “riding” on the door. The function must be set in accordance with the country-specific regulations to ensure that the door comes to a halt and releases if an additional weight load is detected.

The power limit in the CLOSE direction provides safety and protection for persons and objects alike. When the power limit is tripped, the door stops and moves back to the OPEN end-of-travel position.

During learning runs, the operator is adjusted to the door. Among other things, the required force for opening and closing is taught in automatically.

In special fitting situations, the previously taught in force may not be sufficiently high, which can cause unwanted reversing. You can configure the force to be more or less sensitive via special programming.

**⚠ CAUTION**

**Danger of injury resulting from excessive force increase**  
If the force is set too high, the power limit is less sensitive, and the door does not stop on time when closing. This can lead to injury or damage.

- ▶ Do not set the force too high.
- ▶ Check the set force with suitable force measurement equipment for permissible values within the scope of EN 12453 and EN 12445 or the corresponding national regulations.

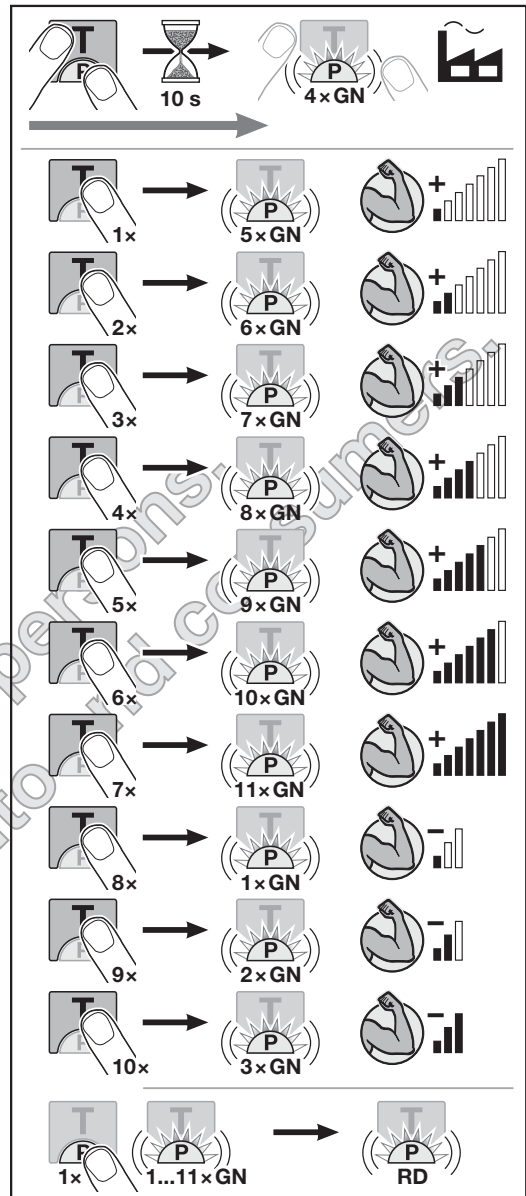

**To change the power limit:**

1. Press and hold the **P** button followed immediately by the **T** button.
2. When the LED flashes green 4 x, release the **T** button and the **P** button (factory setting).
3. Set the force with the **T** button.

T button	LED flashing	Force
Do not press	4 x green	Force after learning run 

Press 1 x	5 x green	Less sensitive (increase in force)
Press 2 x	6 x green	Less sensitive (increase in force)
Press 3 x	7 x green	Less sensitive (increase in force)
Press 4 x	8 x green	Less sensitive (increase in force)
Press 5 x	9 x green	Less sensitive (increase in force)
Press 6 x	10 x green	Less sensitive (increase in force)
Press 7 x	11 x green	Less sensitive (increase in force)
Press 8 x	1 x green	More sensitive (reduction in force)
Press 9 x	2 x green	More sensitive (reduction in force)
Press 10 x	3 x green	More sensitive (reduction in force)

**To change the ventilation position:**

Using the **T** button, move the door to the desired position via the taught-in impulse radio code or an external control element with impulse function (> 120 mm before the CLOSE end-of-travel-position).

4. Press and hold the **P** button followed immediately by the **T** button.
5. When the LED flashes green corresponding to the set power limit value, release the **T** button and the **P** button.
6. Set DIL switch F to ON.  
The LED flashes green for 2 seconds.

**The changed position is saved.**

If the selected position is too close on the CLOSE end-of-travel position, an error message appears (LED flashes red 1 x). The factory-set position is set automatically, or the most recent valid position is maintained.

**To save the selected force**

- Press the **P** button.  
The LED flashes green once according to the force setting. The operator switches back to the previous state. The LED flashes red.

**Timeout**

If you do not press the **P** button within 60 seconds, the force remains in the factory setting.  
The operator switches back to the previous state. The LED flashes red.

**1.2 Changing the ventilation position**

The ventilation position depends on the door type and is pre-set at the factory.

You can change the ventilation position without additional safety equipment via special programming.

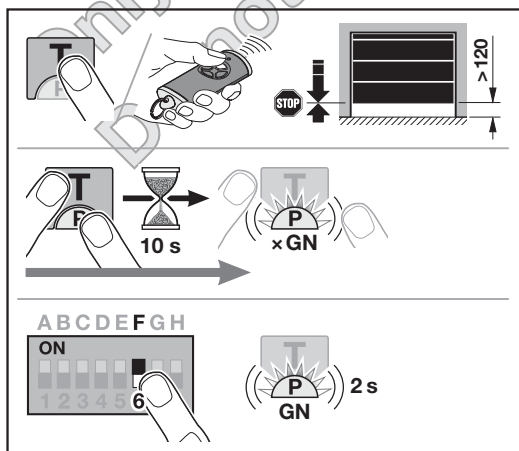

## **ProMatic 4**

HÖRMANN KG Verkaufsgesellschaft  
Upheider Weg 94-98  
33803 Steinhagen  
Deutschland



TR12A133 RE/09.2019